



Specification

规格书

Customer Name: _____

客户名称:

Customer P/N: _____

客户品号:

Factory P/N: WLUW5730B-9205-Y10-RA95

公司品号:

Sending Date: _____

送样日期:

稳亮电子有限公司

WEN LIANG OPTO-ELECTRONICS CO.LTD.

Add: Building 6, Xiaweishui Industrial District,
Hongqiaotou Songgang Street, Bao'an,
Shenzhen, Guangdong, China (513000)

Tel: 0086-755-29785289

Fax: 0086-755-29785189

E-mail: szwenliang@163.com

Website: <http://www.szwenliang.com.cn>



Client approval 客户审核			Wenliang approval 稳亮光电审核		
Confirmation 制作	Approval 核准	Audit 确认	Confirmation 制作	Approval 核准	Audit 确认
				刘东	黎金海
<input type="checkbox"/> Qualified 接受		<input type="checkbox"/> Disqualified 不接受	DATE: 日期:		

注: 1.此规格书以中英文方式书写,若有冲突以中文版本为准文本。

2.此规格书的最终解释权归深圳稳亮电子股份有限公司

3.承认签章后请回复一份(或复印件)给我公司,其余由贵司留存存盘。如果在签章的承认书(或复印件)回复我司之前,下了有关此零件的订单且又无特殊说明,那么我司就确定贵司已完全承认。

Please return one specification or one copy of it with your chop and signature of approval and retain the others for your record. In the event of an order being placed for this part number before the chop and signed with specification (or copy) is returned and without special explanation, it will be assumed that full approval have been given.



TYPE NO: **WLUW5730B-9205-Y10-RA95**

PACKAGE DIMENSIONS (产品尺寸)

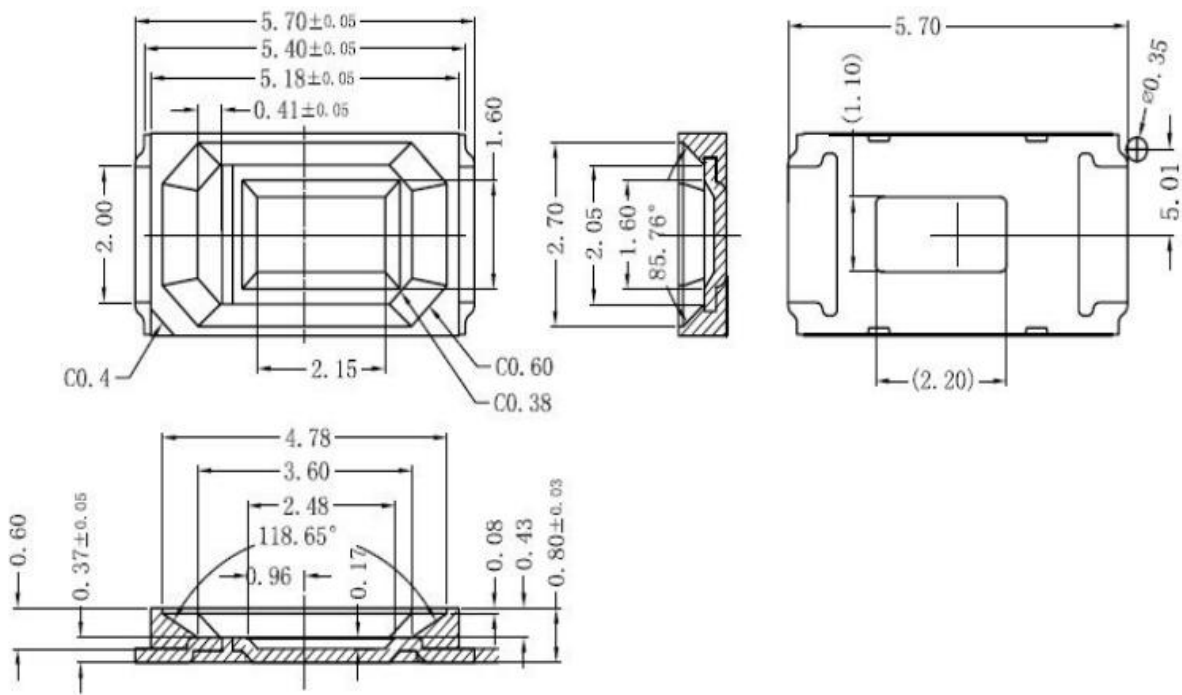

Notes: (备注)

1. All Dimensions are in millimeters (所有尺寸都以毫米为单位)
2. Tolerance is ±0.1mm Unless otherwise specified. (公差为±0.1mm, 除非另有规定)



Device Selection Guide (选择指南)

Emitting Color (发光颜色)	Lens Type (胶体类型)
white	Transparent

Absolute Maximum Ratings at Ta=25°C (绝对最大额定值)

Parameter (参数)	Symbol (符号)	Rating (值)	Unit (单位)
Power Dissipation (功耗)	P _d	480	mW
Peak Forward Current[4] (峰值电流)	I _{FP}	180	mA
Forward Current (正向电流)	I _F	150	mA
Reverse Voltage (反向电压)	V _R	5	V
Operating Temperature (操作温度)	T _{opr}	-40°C to+100°C	
Storage Temperature (保存温度)	T _{stg}	-40°C to+110°C	
Lead Soldering Temperature 【3mm From Body】 (焊接温度)	T _{sol}	260°C For 5 Seconds	

Electrical Optical Characteristics at Ta=25°C (电性与光学特性)

Parameter (参数)	Symbol (符号)	Min (最小)	Typ (平均)	Max (最大)	Unit (单位)	Condition (测试条件)
Forward Voltage (正向电压)	V _F	3.0	3.2	3.4	V	IF=150mA
Luminous Intensity (亮度)	I _V	40	--	50	LM	IF=150mA
Temperature Color (色温)	CCT	2600	--	2800	K	IF=150mA
Color Rendering Index (显指)	RA	95	--	--		IF=150mA
Reverse Current (反向电流)	I _R	/	/	5	μA	VR=5V
Viewing Angle (角度)	2θ1/2	/	120	/	deg	IF=150mA

Notes. (备注)

- 1.The above luminous flux measurement allowance tolerance is ± 11%. (上述发光通量的测试允许公差为±11%)
- 2.The above dominant wavelength measurement allowance tolerance is ± 1NM (以上所示波长测量误差±0.1V.)
- 3.The above forward voltage measurement allowance tolerance is ±0.1V. (以上所示电压测量误差±0.1V.)
- 4.1/10 Duty cycle, 0.1ms pulse width. (脉宽0.1ms,周期1/10)



Typical Electro-Optical Characteristics Curves (典型电光特性曲线)

Relative Luminous Intensity vs Forward Current, $T_{Ambient}=25^{\circ}C$

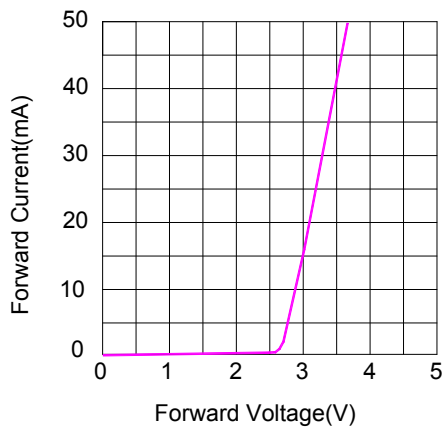

Relative Luminous Intensity vs Forward Current, $T_{Ambient}=25^{\circ}C$

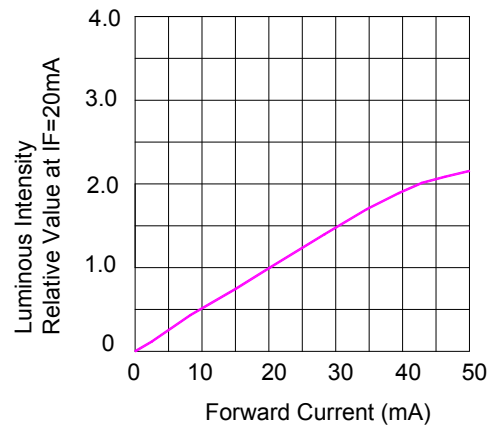

Forward Current Derating Curve, Derating based on $T_{jMAX}=85^{\circ}C$

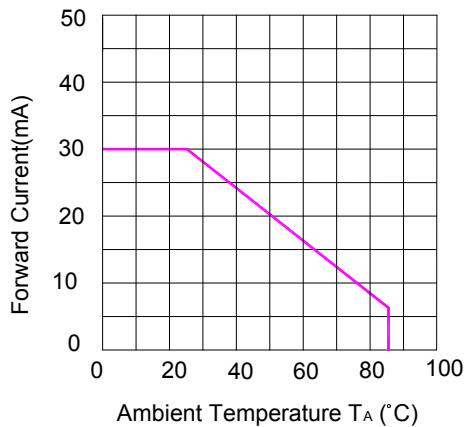

Luminous Intensity VS Ambient Temperature

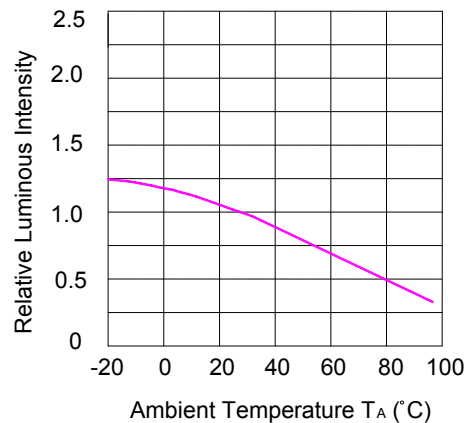

Relative Spectral Distribution, $I_F=20mA$, $T_{Ambient}=25^{\circ}C$

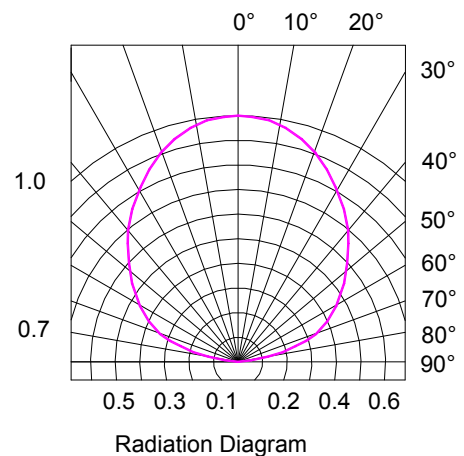
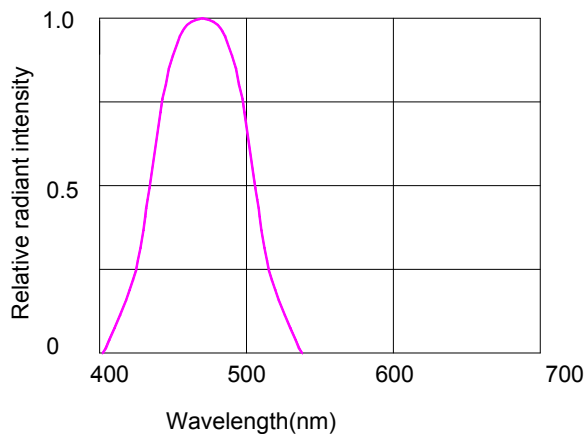



Soldering condition (焊接条件)

Reflow Soldering (回流焊接)			Hand Soldering (手工焊)	
	Lead Solder (铅焊料)	Lead – free Solder (无铅焊料)		
Pre-heat (预热温度)	120~150°C	180~200°C	Temperature	350°C Max.
Pre-heat time (预热时间)	120sec. Max.	120sec. Max.	Soldering time	3sec. Max. (one time only)
Peak temperature (峰值温度)	240°C Max.	260°C Max.		
Soldering time (焊接时间)	10sec. Max.	10sec. Max.		
Condition (状态)	refer to Temperature- Profile 1	refer to Temperature- Profile 2		

Temperature profile in re-flow machine for lead type and lead free type (铅型和无铅型回流机的温度分布图)

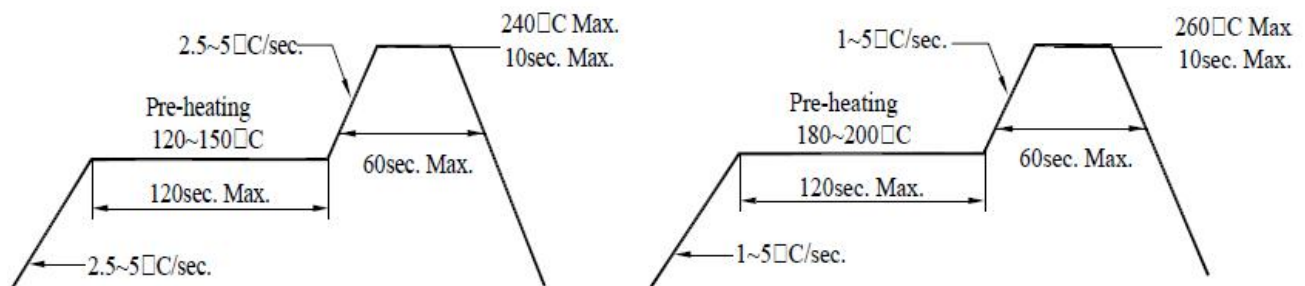

Dimension of carrier tape (载带尺寸)

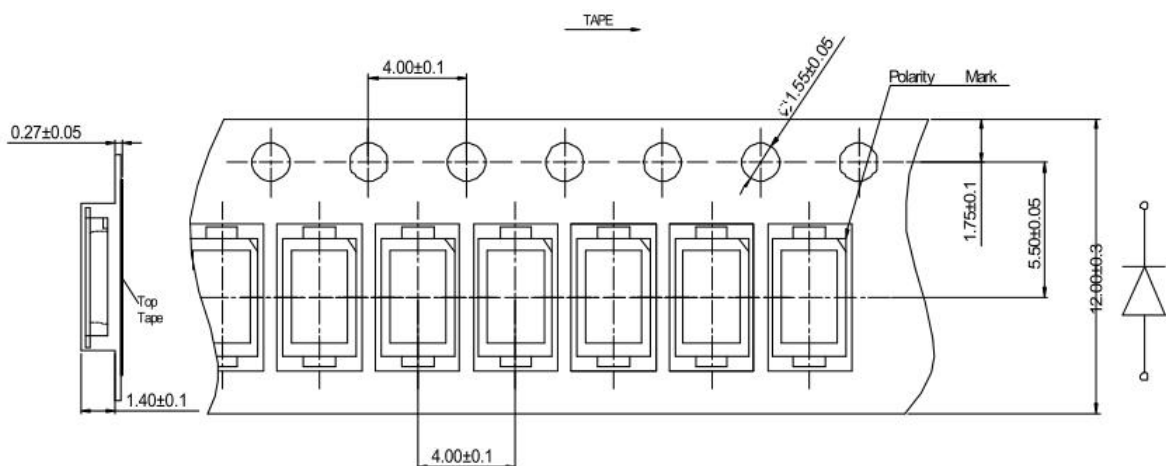



Dimension of reel (卷盘尺寸)

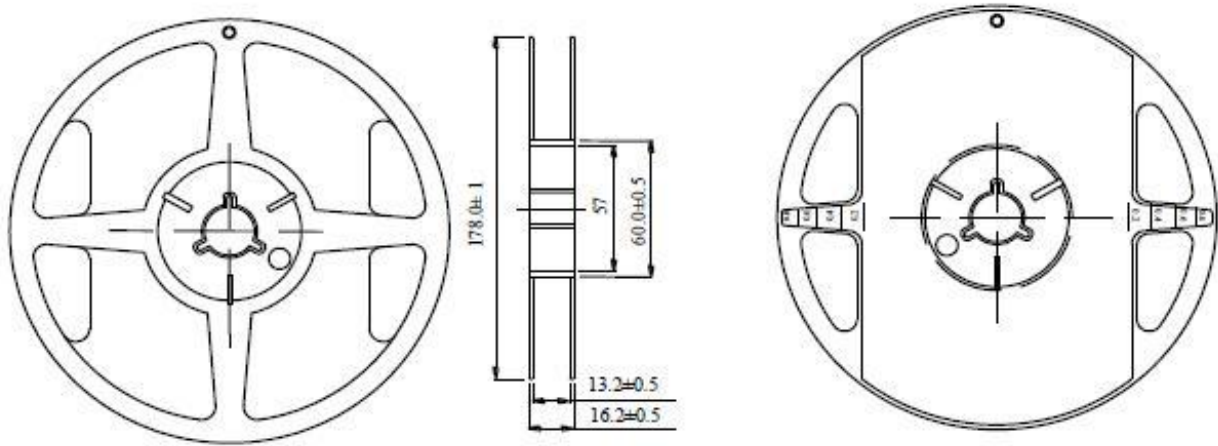

Notes: (备注)

1. All dimensions are in mm, tolerance is ± 2.0 mm unless otherwise noted.
(所有尺寸均为毫米, 公差为 ± 2.0 mm, 除非另有说明。)
2. Specifications are subject to change without notice.
(规格如有更改, 恕不另行通知。)

Packing (包装)

1. 2000 piece of SMD 5730 Products on one reel. The reel will be put in the anti-static bag, then sealed.
(2000 片 SMD 5730 产品在一个卷筒上。卷筒将放在防静电袋中, 然后密封。)
2. 2000 piece of SMD 5730 products on one bag.
(2000 件 SMD 5730 产品在一个袋子上。)



注意事项:

1. 通过使用适当的工具从材料侧面夹取，不可直接用手或尖锐金属压胶体表面，它可能会损坏内部电路

Through the use of appropriate tools from the material side of the clip, can not be directly used by hand or sharp metal pressure on the surface, it may damage the internal circuit

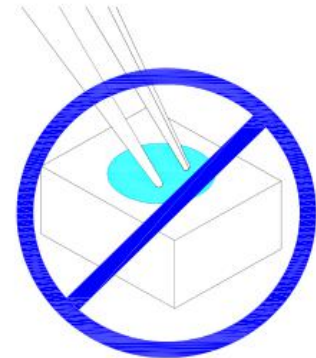
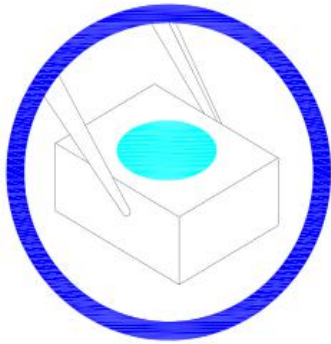

2. SMD 吸咀外径不可超过 LED 尺寸，吸咀内径尺寸应尽可能大，吸咀顶端材质建议采用柔软材料以防在吸取期间刮伤或损坏 LED 胶体表面，元件的尺寸必须在取放机里准备的编程好，以确保精确的吸取和避免生产过中的损害

SMD suction nozzle diameter can not exceed the size of LED, the suction mouth battle size should be as large as possible, ceiling tip top material suggestions made of soft material to prevent absorb during scraping injury or damage the LED colloid surface, the size of the components must be in good pick and place machine to programming to ensure accurate absorption and avoid damage in production



3. 不可将模组材料堆积在一起，它可能会损坏内部电路
Do not stack together assembled PCBs containing LEDs. Impact may scratch the silicone lens or damage the internal circuitry



4. 不可用在 PH<7 的酸性场所
Not suitable to operate in acidic envi-ronment, PH<7





4.LED 工作环境与 LED 适配的材料中硫元素及化合物不可超过 100PPM

LED working environment is very suitable for the materials of LED and sulfur elements and compounds can not be more than 100PPM

5.当我们需要使用外封胶涂抹 LED 产品时，应确保外封胶与 LED 封胶胶水相匹配，因为大多数 LED 的封装胶水为硅胶，它有较强的的氧化性和较强的吸湿性。

When we need to use seal glue smearing LED products should be really warranty seal glue and led sealing glue glue to match, because most of the LED package glue is silica gel, it has strong oxidation resistance and strong hygroscopicity

6. 在开包装之前，请先检查包装袋有无漏气，如有漏气现象，请退回我司重新除湿包装再使用。
Before opening the package, please check the packing bag is free of leakage, if there is leakage phenomenon, please return the division to re - use the packaging and re - use

7. 要在规定环境条件中使用：温度 30℃以内，湿度 60%RH 以下

To be used in the provisions of the environmental conditions

8. 折包使用前：请用 70℃除湿 24 小时后才可以使用

Please use 70 degrees 24 hours before you can use the10 after the use of the material is more than 24H of the use of time is not used up

9. 材料拆装后使用时间超过 24H 未用完，需烘烤 70℃/24 小时除湿才可使用。

Need to bake 70 degrees /24 hours before the use of the desiccant can be used